

PAR[®] Phase[™]

VESA Mount Plate Installation Guide (K9120)

15.6" Display Wall-Mount Plate Compatible with VESA 100mm mounts

Note: Power must be turned OFF and power cord disconnected to complete plate installation

⚠ WARNING! Removing service parts that contain the warning sign will defeat important fire safety enclosures and may expose users to hot parts. The cover is snap fit but is only intended for use by service personnel.



Remove the two screws as shown and set aside



Remove the top strip by lifting it off of the terminal



Remove the two screws as shown and set aside



Remove connector attached to the panel and tuck the wires into the exposed receptacle



The panel may now be removed and set aside



Insert the mounting plate base tabs into the drilled screw slots as shown



Fasten the screws in the top position

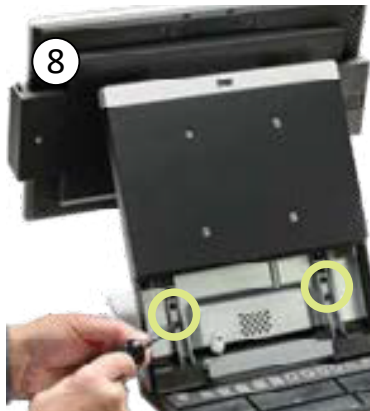

Remove screws at the base of the mounting plate & pull the display off of the pedestal to mount



The completed assembly fits any 100mm VESA mount

Additional Information

Support Information

One year mail-in warranty, additional service options are available.

For Service:

USA: 800.382.6200

Canada: 800.387.4963

Parts:

USA: 800.PAR.PART

Canada: 800.387.4963

Driver Support:

support.partech.com

Terms and Conditions

Read, understand, and follow all safety information contained in these instructions prior to installation & operation of PAR systems. Failure to follow all instructions listed could result in electrical shock, fire and/or other personal injury. Retain these instructions for future reference.

Revised 5/2021

Safety Information

⚠ This product contains chemicals, including lead, which is known to the State of California to cause cancer, birth defects or other reproductive harm. For more information, go to www.P65Warnings.ca.gov

⚠ WARNING! Removing service parts that contain the warning sign will defeat important fire safety enclosures and may expose users to hot parts. The cover is snap fit but is only intended for use by service personnel.

⚠ AVERTISSEMENT! Le retrait des pièces de rechange qui contiennent le signe d'avertissement détruira les enceintes de sécurité incendie importantes et peut exposer les utilisateurs aux pièces chaudes. Le couvercle est encliquetable mais est uniquement destiné à être utilisé par le personnel d'entretien.

WARNING! Do not mount the terminal over 2 meters above floor level.

AVERTISSEMENT! Ne montez pas le terminal à plus de 2 mètres au-dessus du niveau du sol.

CAUTION! Always ensure that the device has adequate ventilation and air flow. Covering the devices can trap heat and redirect it back to the device, causing damage.

MISE EN GARDE! Assurez-vous toujours que l'appareil dispose d'une ventilation et d'un débit d'air adéquats. Couvrir les appareils peut emprisonner la chaleur et la rediriger vers l'appareil, causant des dommages.

WARNING! To reduce the risk associated with hazardous voltage:

- Disconnect power before installing or removing power supply.
- If power supply is supplied with a grounding pin, connect directly to a grounding receptacle – 3 prong.
- Do not use if the power supply cord or enclosure is damaged.
- Use the power supply indoors and in dry locations only.

ATTENTION! Pour réduire le risque associé à une tension dangereuse :

- Débranchez l'alimentation avant d'installer ou de retirer l'alimentation.
- Si l'alimentation est fournie avec une broche de mise à la terre, connectez-la directement à une prise de terre à 3 broches.
- Ne pas utiliser si le cordon d'alimentation ou le boîtier est endommagé.
- Utilisez l'alimentation à l'intérieur et dans des endroits secs uniquement.

WARNING! Never dispose of batteries in a fire because they may explode. Do not disassemble, crush, puncture, heat, burn, or reuse.

ATTENTION! Ne jetez jamais les piles au feu car elles pourraient exploser. Ne pas démonter, écraser, percer, chauffer, brûler ou réutiliser.

CAUTION! Risk of explosion if battery is replaced by incorrect type. Dispose of used batteries according to the following instructions.

ATTENTION! Risque d'explosion si la batterie est remplacée par un type incorrect. Jetez les piles usagées conformément aux instructions suivantes.

CAUTION! To reduce the risks associated with environmental contamination due to battery pack:

- Dispose of batteries, power supplies, battery charger and all other electrical components in accordance with federal, state & local requirements. If preferred, return these components to PAR Service Center for recycle.
- Many rechargeable batteries are required to be recycled by local, state/province, and national laws. To properly recycle/dispose of the battery or battery pack, always follow local solid waste disposal regulations.

US and Canada Disposal Information

In the United States and Canada, PAR is partnering with Call2Recycle Rechargeable Battery Recycling Corporation (RBRC) to provide you recycling service to ensure that the rechargeable batteries within our products are recycled properly. To assist you in using this service call the Call2Recycle battery recycling information help line at 1-800-822-8837 or go to call2recycle.org

FCC Compliance and Industry Canada Information

FC This device complies with part 15 of the FCC Rules and ISSED Canada standards. Operation is subject to the following two conditions: (1) this device may not cause harmful interference, and (2) this device must accept any interference received, including interference that may cause undesired operation.

EU Compliance

CE This device complies with Directive 2014/53/EU.

European Union Disposal Information

WEEE This symbol means that according to local laws and regulations your product and/or its battery shall be disposed of separately from household waste. When this product reaches its end of use, take it to a collection point designated by local authorities.

PAR Technology Corporation
8383 Seneca Turnpike
New Hartford, NY 13413
Phone: (315) 738-0600
www.partech.com

© 2020 PAR Technology Corp.
All Rights Reserved

This material has been created in order to accommodate a wide range of restaurant operations and your specific business practices and system configuration may differ slightly from what is represented in this material. While ParTech, Inc. ("PAR") takes great care to ensure the accuracy of these materials, all material is provided "as is" without warranty of any kind, either express or implied, including, but not limited to, warranties of merchantability or fitness for a particular purpose. PAR does not make any warranties or representations that the materials will meet your requirements or that the operations of the hardware will be uninterrupted or error free.

Trademark Notices: The PAR logo is a trademarks of PAR Technology Corporation, the parent company of ParTech, Inc. or its affiliates. All other product names used throughout this material are trademarks of the respective companies. No such use of any trademark is intended to convey endorsement or other affiliation with these companies.

Reproduction: Copyright © 2020 ParTech, Inc. All rights reserved. This publication, or any part thereof, may not be reproduced or transmitted in any form or by any means, electronic or mechanical, including photocopying, recording, storage in an information retrieval system, or otherwise, without the prior written permission of ParTech, Inc., PAR Technology Park, 8383 Seneca Turnpike, New Hartford, NY 13413-4991 USA